

RAINHAM STEEL

PHONE: 01708 522311 FAX: 01708 559024

Wire Spacers

Linchairs

Dual Purpose supports for spacing bars and fabric in two metre standard lengths.

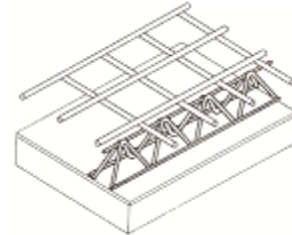

LARGER SIZES AVAILABLE

Code	Height mm	Bundle Size
RSD 50	50	20
RSD 60	60	20
RSD 70	75	20
RSD 90	90	20
RSD 106	105	20
RSD 120	120	20
RSD 136	135	20
RSD 150	150	20
RSD 160	165	20
RSD 200	200	20

Circular Spacers

The most economical way of supporting top steel in slabs with a 3.2/3.6m strip bent and tied to form a 1.000/1.100 diameter circle 2-3 per sheet are normally sufficient.

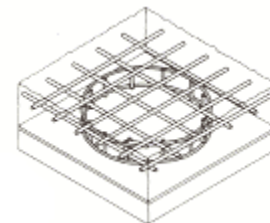

Code	Height mm	Bundle Size
RCS 60	60	25
RCS 75	75	25
RCS 90	90	25
RCS 105	105	25
RCS 120	120	25
RCS 135	135	25
RCS 150	150	25
RCS 165	165	25
RCS 180	180	25
RCS 200	200	25

Concrete Spacers

Spacemen & Meshmen

Spacemen are a range of heavy duty fibrous cement spacer blocks for the horizontal and vertical spacing of reinforcement steel bars and fabric.

Spacemen		
Code	Cover	Pack Size
Triple Cover		
RSM 25	25/30	500
RSM 50	35/40/50	200
Double Cover		
RSM 60	60/75	50
RSM 70	70	50

Meshmen		
Code	Cover	Pack Size
RMM 40/50	40/50	100

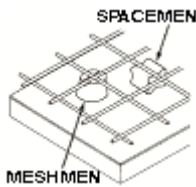

Meshmen are a heavy duty concrete block for supporting fabric or reinforcing bar off polythene membranes.

Concrete Square Bars

Concrete section, heavy duty fibrous cement spacer bar. Supplied in 1 metre length.

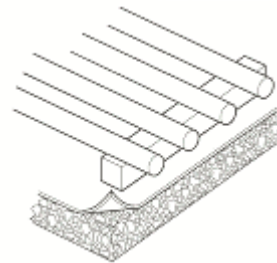

Code	Cover
RSB 25	25mm
RSB 30	30mm
RSB 40	40mm
RSB 50	50mm
RSB 60	60mm
RSB 70	70mm
RSB 75	75mm

Slab Accessories

Crack Inducers
Rigid PVC extrusions for use in contraction and warping joints in concrete slabs.

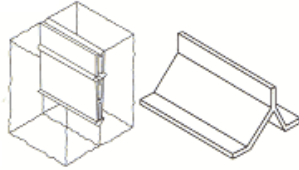

Ref	Depth mm	Length M
Top type (used as one or two piece)		
CT 50	50	5
CT 75	75	55
Bottom Y type		
BY 40	40	5
BY 75	75	5

Void Formers
A re-usable PVC void former for forming grooves in concrete or nailing to formwork. All supplied in 3 metre lengths.

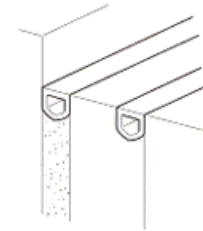

Ref	Size mm
VF 20x20	20x20
VF 25x25	25x25
VF 20x10	20x10
VF 20x12	20x12

Joint Filler Board
Woodfibre joint filler board impregnated with bitumen emulsion. For use in expansion and separation joints.

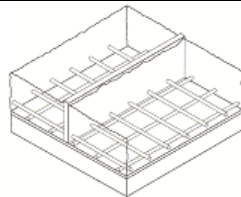

Ref	Size mm
JFB 100/12	2440x100x12
JFB 150/12	2440x150x12
JFB 200/12	2440x200x12
JFB 250/12	2440x250x12
JFB 150/20	2440x150x20
JFB 200/20	2440x200x20
JFB 250/20	2440x250x20
JFB 150/25	2440x150x25
JFB 200/25	2440x200x25
JFB 250/25	2440x250x25

Foam Fillerboards
A closed cell polythene foam for use as Fillerboard in all types of joints including Concrete floor slabs and brickwork. Available in 10m coils supplied with perforated tear off strip.

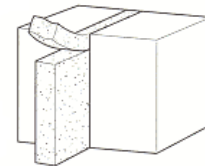

Ref	Size	Ref	Size
FFB 100x10	100x10	FFB 125X15	125x15
FFB 125x10	125x10	FFB 150X15	150x15
FFB 150X10	150x10	FFB 175X15	175x15
FFB 200X10	200x10	FFB 200X15	200x15
FFB 100X12	100x12	FFB 125X20	125x20
FFB 125X12	125x12	FFB 150X20	150x20
FFB 150X12	150x12	FFB 175X20	175x20
FFB 200X12	200x12	FFB 200X20	200x20

Screedrail

The most up to date and economical method of slab construction available to the contractor. Screedrail is manufactured in reinforced concrete with a material strength of 50 N/mm². It comes in a range of heights to suit any thickness of slab under construction. The adopted profile allows for maximum bond between adjacent bays with holes provided for the insertion of dowel bars.

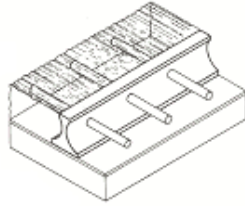

Ref	Height mm	Length M	Slab Thickness mm
RCSR 50	50	3	N/A
RCSR 100	100	3	125 – 150
RCSR 150	150	3	175-250

Metal top screedrail

An ideal Screedrail for use where a super flat floor finish is required. This rail is a combination of concrete with a galvanized steel top inset.

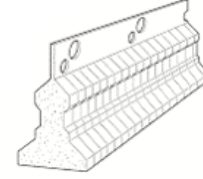

Ref	Height mm	Length M
RSMR	65	3.900
RSMR	90	3.900
RSMR	115	3.900
RSMR	140	3.900
RSMR	165	3.900

Waxed cardboard bolt boxes

Conical foundation bolt boxes to form cavities in foundations for holding down bolts.



Ref	Length mm (ins)	Approx. diameter mm	
		Top	Bottom
CB1	229 (9)	70	20
CB2	305 (12)	92	20
CB3	380 (15)	108	25
CB4	457 (18)	114	30
CB5	534 (21)	118	30
CB6	610 (24)	113	30

Polystyrene Bolt Boxes

Foundation bolt boxes to form cavities in foundations for holding down bolts.

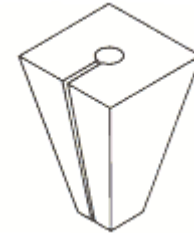

Ref	Size	Length mm (ins)
PC1	8	203 (8)
PC2	9	229 (9)
PC3	12	Tapering from 305 (12)
PC4	15	100mm With 380 (15)
PC5	18	25mm diameter hole. 457 (18)
PC6	21	534 (21)
PC7	24	610 (24)

Holding Down Bolts

Holding down bolt assemblies comprising of a bolt, washer plate (100mm x 100mm x 6mm), nut and washer with a range from 16mm to 30mm diameter and lengths from 200mm to 600mm depending on type.

Available in either grade 4.6 or 8.8 material or with washer plates of 8mm or 10mm thickness.

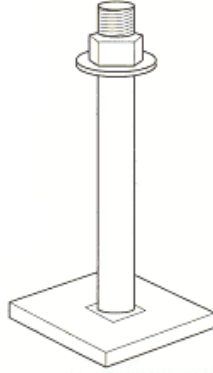

Building Films – Specialist

Use

Damp proof membrane for use in ground floor and road slabs. Blue tinted.

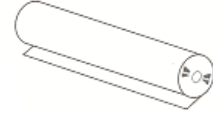

Ref	Width M	Length M	Thick mu	Gauge	Roll Weight kg
PIFA Standard					
DPMP 250	4	25	250	1000	23
DPMP 300	4	25	300	1200	27.6
DPMP 500	4	12.5	500	2000	23
BBA Standard					
DPM 250	4	25	250	1000	23
DPM 300	4	25	300	1200	27.6
Building regulations standard					
DPMS 300	4	25	300	1200	27.6

Plastic Screed Chairs

Manufactured from plastic, fully adjustable, ideal for light duty applications. For use with a 50mm diameter pole.

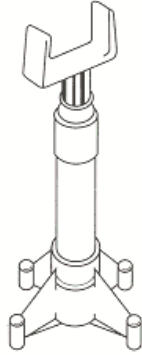

Ref	Part
SCS	Saddle
SCC	Collar
SCB	Base

Metal Screed Chairs

Supplied in two parts, the height is easily adjusted by turning the stirrup in the base.

Other sizes and combinations are available on request.



Ref	Height mm	Slab thickness mm	Pack Qty	
Stirrup	Base			
MSCS100	MSCB65	65	120-150	1
MSCS125	MSCB90	90	150-200	1
MSCS175	MSCB140	140	200-300	1

Corrugated Beam Form

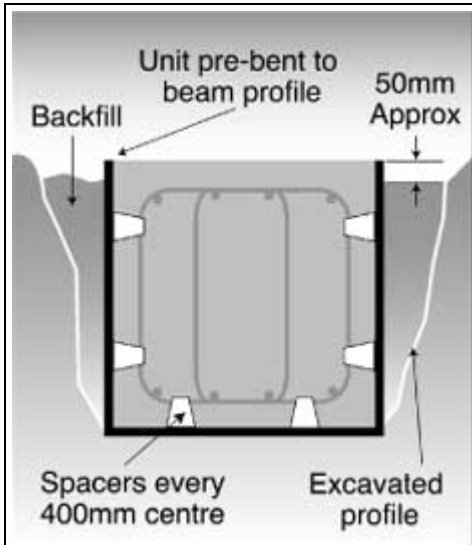

U-shaped corrugated beam form placed in levelled excavated surface.

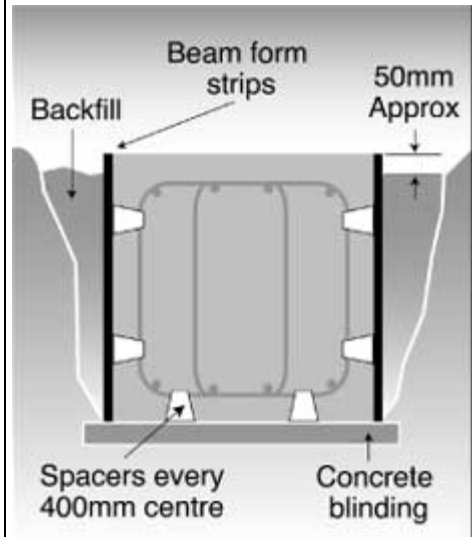

Strips of corrugated beam form supplied for pile caps, bases or beams and supported on concrete blinding.

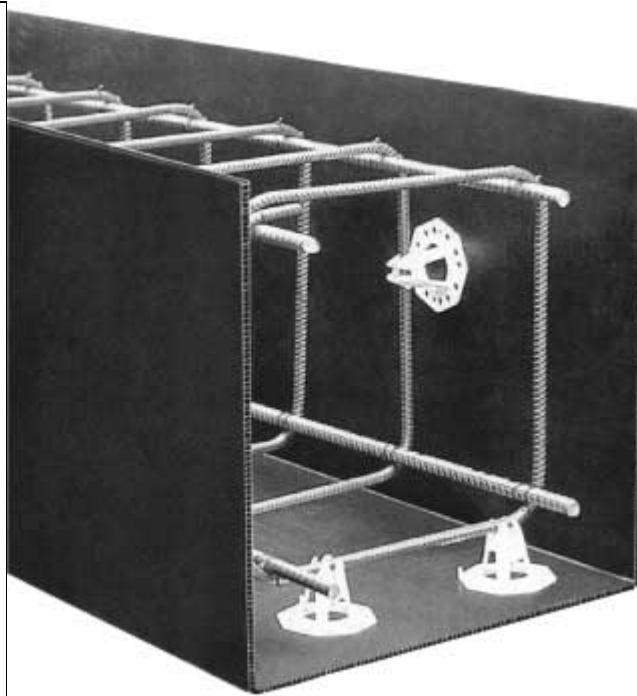

Supply Options

Corrugated beam is supplied in standard size sheets, 4.8m x 2.4m x 8mm and can be cut and bent on any site by the contractor.

Alternatively provide us with a layout and we will supply the beam form pre-cut to your requirements.

- Tough high matt PVC tape supplied in 50mm x 30m rolls
- Draper high quality cutting knife with belt holster

Rebar Couplers

Advantages of the ALC-ST coupler

- No special preparation of the reinforcement bar required.
- Fast, simple and easy to use
- Correct placement can be verified easily by visual inspection
- No specialist tools required
- No specialist training required to fix the product
- Suitable for all types of reinforcement steel construction applications
- Ensures integral connection of reinforcement steel
- Reduces congestion where heavy bars are being used at close intervals
- Eases concrete application and vibration
- Reduces the risk of voids
- No rotation of reinforcement bar is required
- Conforms to European and United States standards
- Fully approved with certification from KOMO K21098/05

Type	Diameter Steel	Number of bolts / coupler	Torque/ bolts (Nm)	SW	Dimensions (mm)								Weight Kg	
					L	d	dl	H	H1	H2	h	hl		h2
ALC-ST 12	12	6	90-99	13	180	35	33	51	35	16	40	24	16	0.93
ALC-ST 16	16	8	90-99	13	230	40	38	57	39	18	45	27	18	1.39
ALC-ST 20	20	10	90-99	13	280	47	44	63	42	23	52	31	23	2.19
ALC-ST 25	25	12	170-187	17	390	56	52	75	45	30	63	33	30	4.51
ALC-ST 32	32	14	350-385	22	480	73	68	91	60	31	77	46	31	9.42
ALC-ST 40	40	18	400-440	22	580	79	73	103	67	36	85	49	36	12.49

Meshfix

A double cover plastic chair designed to support fabric or rebar off polythene damp proof membranes. In ground slab construction

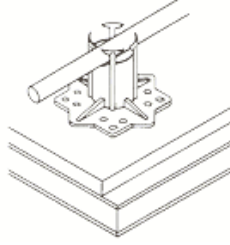

Code	Cover	Pack Size
RMF 40/50	40 + 50	250
RMF 65/75	65 + 75	125
RMF 90/100	90 + 100	100

Plastic Track

A versatile plastic spacer that can be used on both horizontal and vertical surfaces.

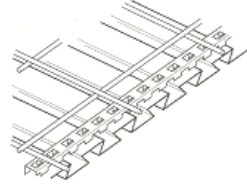

Code	Size
PT 20	20mm
PT 25	25mm
PT 30	30mm
PT 35	35mm
PT 40	40mm
PT 50	50mm

Circular Bar Spacers

Injection moulded plastic bar spacer for use with beams and columns.

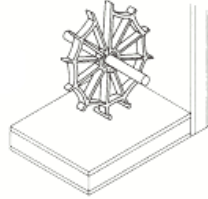

Code	Cover mm	Bar Size	Pack
15 CBS 08	15	4-8	1000
20 CBS 08	20	4-8	1000
20 CBS 12	20	8-12	1000
25 CBS 12	20	8-12	500
25 CBS 20	25	16-20	500
30 CBS 12	30	8-12	250
40 CBS 12	40	8-12	250
50 CBS 12	50	8-12	250

Clip Chair Spacer

A lightweight range plastic spacer designed for the pre-caster to take bars up to 12mm diameter and a heavy duty range for bars up to 20mm diameter.

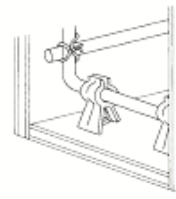

Code	Cover	Bar Size mm	Pack
RCC 20	20	6-12	250
RCC 25	25	6-12	250
RCC 30	30	6-12	250
RCC 40	40	6-20	250
RCC 50	50	6-20	250

Tying Wire & Tool

Double Loop Ties & Tying Tool

Double loop ties, manufactured from 17 gauge, annealed plain wire for use with plain reinforcement.

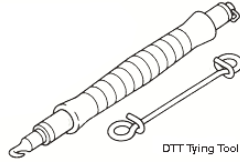

Ref	Length	Pack Size
DL 100	100	1,000
DL 150	150	1,000
DL 200	200	1,000

Tying Wire

1.6mm (16 gauge). Fully annealed tying wire for use with plain reinforcement.

1.22mm (18 gauge).

Stainless steel wire for use with stainless steel reinforcement.

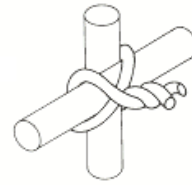

Ref	Coil weight kg
Annealed	
PW A 25	25
PW A 2	2
Stainless Steel	
SW S	25

Brick Reinforcement

Galvanised or stainless steel Masonry Reinforcement offers a low cost solution to the corrosion problems associated with conventional reinforced masonry.

The lightweight ladder and lattice type reinforcement is highly ductile and readily cut and shaped on site.

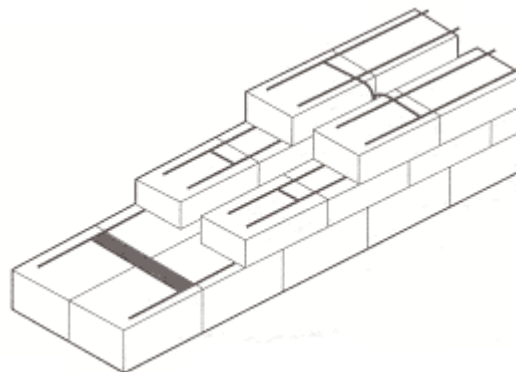

Dowel Range

Dowel Bar Caps

Rigid PVC type with compressible cork fixed in one end to allow for expansion of dowel bars within the joint.

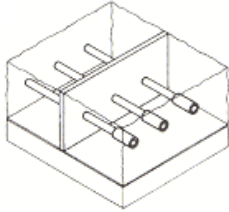

Code	Length mm	Pack Quantity
RDS 12	125	100
RDS 16	125	100
RDS 20	125	100
RDS 25	125	100
RDS 32	125	100
RDS 40	125	100

Dowel Bar Sleeves

Plastic dowel bar de-bonding sleeve for use in dowelled contraction joints can be supplied complete with flexible foam plug for use in expansion joints.

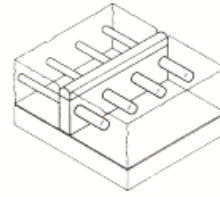

Code	Length mm	Pack Quantity
RDS 12	450	100
RDS 16	200	100
RDS 20	300	100
RDS 25	300	100
RDS 32	375	100

Dowel Bar Cages

Dowel Bar Cages

Dowel bar cages are used to support dowel bars in expansion and contraction joints of road and slab construction. They are manufactured in one metre lengths to suit any slab thickness.

H = height from base to underside of dowel bar.

Please confirm this height when ordering.

All dowel bar cages are made to order.

Note: Two lengths required per metre run of joint.

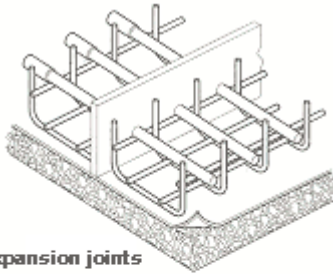

Expansion joints

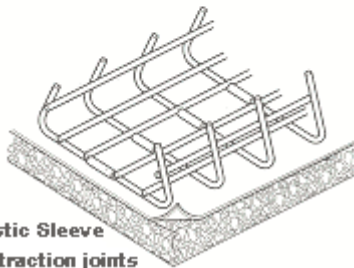

Plastic Sleeve
Contraction joints



Height h=mm	Code
65 to 80	DC 080 EXP
81 to 115	DC 115 EXP
116 to 155	DC 155 EXP

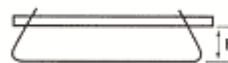

Also available:

De-bonding compound – 5 litres or 25 litres.

Formwork Accessories

Produced from a high tensile steel with a screw thread (deformation conforming to ASTM A 618 for reinforcing steel bars).

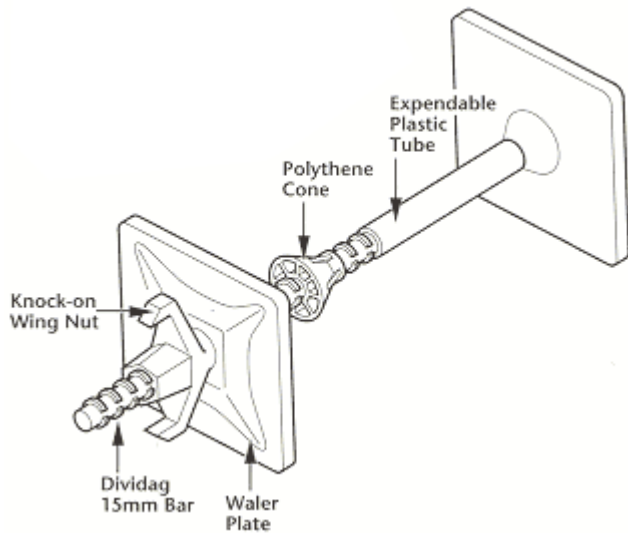

Physical Data:

Diameter:	Net 17mm
Weight per metre	1.44kg
Approx. failing load	191 kN
Max. safe workload	127 kN

Thru Sleeve

A rigid PVC tube of 2mm wall thickness, supplied in 2 metre lengths which can be easily cut to the required size. It is used as an expendable sleeve over tie bolts, facilitating their removal and also acting as a spacer to ensure correct width of wall.

Thru Cones

Thru Cones are used at the ends of the Thru Sleeve and can be easily extracted after removal of the formwork, to form a chamfered recess for subsequent grouting.

Also available:

Formwork Clamps, Flexible Hose, Adjustable Kickers

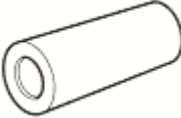
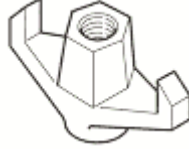
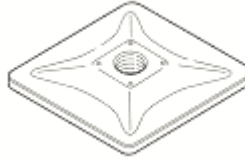
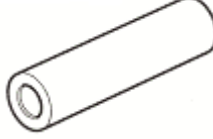
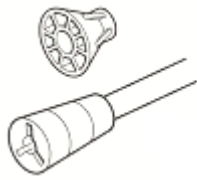
Tie Bar 	<table border="1"> <thead> <tr> <th>Length M</th> </tr> </thead> <tbody> <tr><td>7.5</td></tr> <tr><td>6.0</td></tr> <tr><td>2.5</td></tr> <tr><td>2.0</td></tr> <tr><td>1.75</td></tr> <tr><td>1.50</td></tr> <tr><td>1.00</td></tr> </tbody> </table>	Length M	7.5	6.0	2.5	2.0	1.75	1.50	1.00
	Length M								
	7.5								
	6.0								
	2.5								
	2.0								
	1.75								
1.50									
1.00									
Connector 									
Wing Nut 									
Waler Plate 	<table border="1"> <thead> <tr> <th>Type</th> </tr> </thead> <tbody> <tr> <td>Std. Heavy Duty</td> </tr> </tbody> </table>	Type	Std. Heavy Duty						
Type									
Std. Heavy Duty									
Thru Sleeve 	<table border="1"> <thead> <tr> <th>Tube i/d o/d</th> </tr> </thead> <tbody> <tr><td>14/18</td></tr> <tr><td>20/24</td></tr> <tr><td>22/26</td></tr> <tr><td>26/30</td></tr> <tr><td>32/38</td></tr> </tbody> </table>	Tube i/d o/d	14/18	20/24	22/26	26/30	32/38		
Tube i/d o/d									
14/18									
20/24									
22/26									
26/30									
32/38									
Thru Cones 	<table border="1"> <thead> <tr> <th>Tube i/d mm</th> </tr> </thead> <tbody> <tr><td>14</td></tr> <tr><td>20</td></tr> <tr><td>22</td></tr> <tr><td>26</td></tr> <tr><td>32</td></tr> </tbody> </table>	Tube i/d mm	14	20	22	26	32		
Tube i/d mm									
14									
20									
22									
26									
32									